

TRIP REPORT

RIVER: SOUTH PLATTE
 DATE OF TRI: APRIL 26-27 1980
 WATER LEVEL: FULL BANK CONDITIONS TEMP. 47°F
 LENGTH & TIME: 30 miles - 2 DAYS
 DIFFICULTY: EASY
 PUT IN: MASTERS COLO.
 TAKE DIRT ROAD 1 MILE NORTH OF
 MASTERS ON RT 34 WEST OF GRIFFIN
 PUT IN AT BRIDGE (PARK AT RAIL ROAD CROSSING)
 TAKE OUT: FT. MORGAN COLO. (1/4 MILE NORTH)
 RIVER SIDE PARK 1/4 MILE NORTH OF
 I 76 ON RT 52 (SE CORNER OF BRIDGE
 AND RIVER INTERSECTION)
 BROKEN GEARS AND
 ROUGH ROCKY BANK
 CAR SHUTTLE TIME: 1 1/2 HOURS

MILES	LAND MARK	DESCRIPTION OF TRIP
1	BRIDGE	{ THERE IS 1 OTHER SMALL DAM IN THE 1 st 1/3 OF TRIP. SOME RAN IT SOME PORTAGE ON RIGHT
3	"	
2.5	"	
5	DAM	PORTAGE AND CAMP ON LEFT
8	BRIDGE	
1.3	"	
7.5	DAM	PORTAGE ON RIGHT OF SOUTH DAM
9.5	BRIDGE	GO UNDER = TAKE OUT ON RIGHT

DANGERS: CHECK UNDER ALL BRIDGES
 FOR WIRE FENCES

NOTE: Trip leaders are responsible to complete and mail trip report to the RMCC president for the RMCC trip report library after every trip.

TRIP REPORT

RIVER: St. Vrain And South Platte

DATE OF TRIP: May 4, 1980

WATER LEVEL: Very High Flooded Out of banks two feet.

LENGTH & TIME: 17 miles (?) 2½ hrs on the water + 1 Hr. for lunch = 3½ hrs.

DIFFICULTY: Easy-intermediate due to high water and swift current.

PUT IN: S.H. 66 at St. Vrain River. Kurtz Cattle Co., 785-2353, owns the land in this area. Frank Kurtz was very nice about us using the put-in point, but wants to know in advance when we are going to use it so he can alert his workers that we will be there.

TAKE OUT: Twin Bridges east of Milliken. Take out on the left upstream of the west bridge.

CAR SHUTTLE TIME: 45 minutes.

DESCRIPTION OF TRIP

The trip was much faster than normal due to the high, swift flowing water. We had no trouble with fences, presumably because they were all under water. There were two road bridges and one railroad bridge before the confluence with the Platte. No clearance problems, although we did have to duck very low once. We did have a cross current problem with the railroad bridge. There is a diversion dam just downstream of the railroad bridge which feeds water into the Ft. St. Vrain Nuclear power plant. This is normally unrunnable, (portage on the left) but this time it was completely under water, and we all ran it. The water was too high to get under the bridge at Milliken.

M. Bruce Waters

NOTE: Trip leaders are responsible to complete and mail trip report to the RMCC president for the RMCC trip report library after every trip.

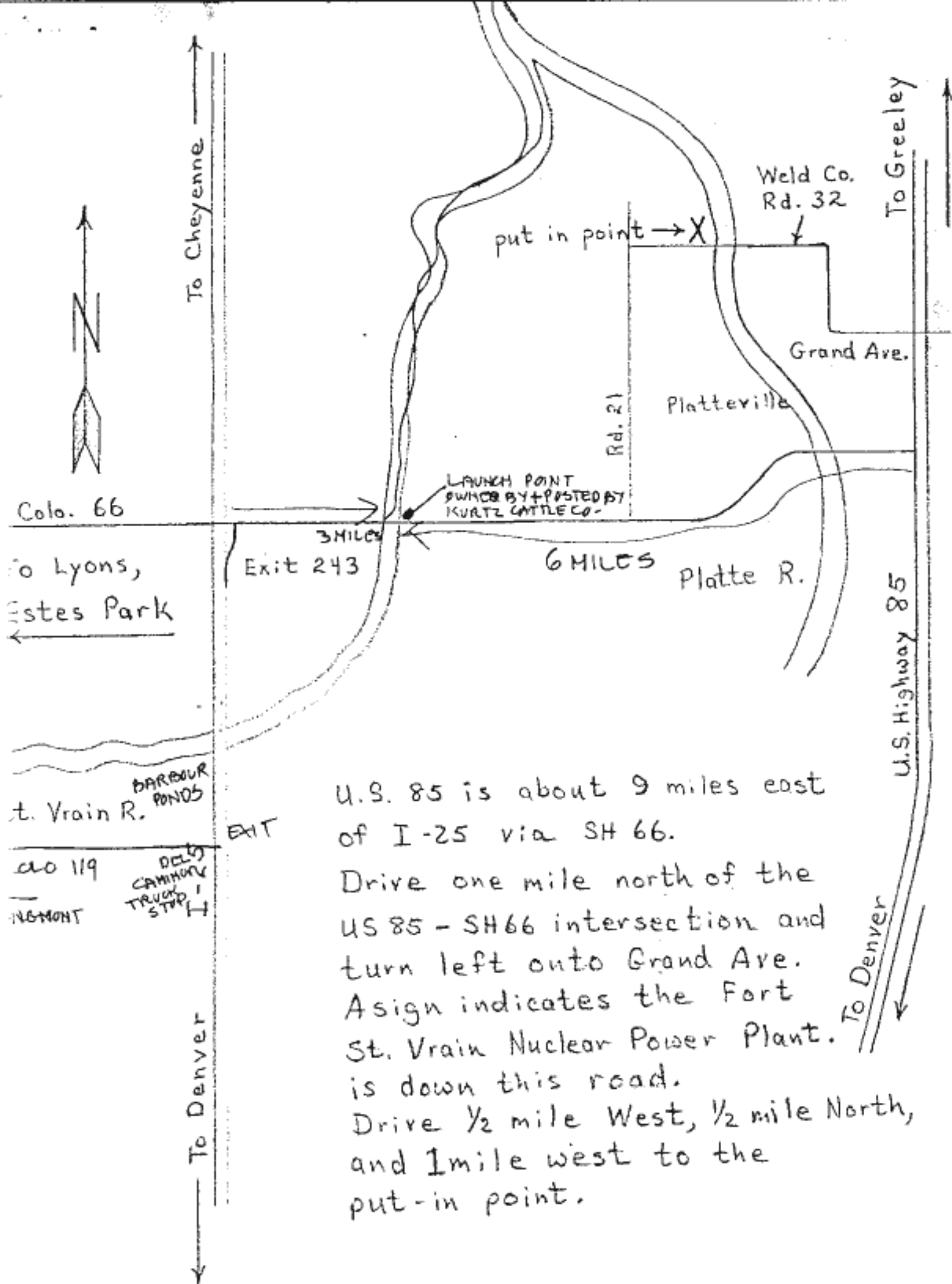

U.S. 85 is about 9 miles east of I-25 via SH 66.

Drive one mile north of the US 85 - SH66 intersection and turn left onto Grand Ave. A sign indicates the Fort St. Vrain Nuclear Power Plant. is down this road.

Drive 1/2 mile West, 1/2 mile North, and 1 mile west to the put-in point.

SCARY NYRE
11075 W. 58th Ave
ARVON, Colo.
80004

TRIP REPORT

RIVER: Colorado River Loma To Westwater

DATE OF TRIP: May 3-4 1980

WATER LEVEL: High (Fast Flowing)

LENGTH & TIME: 27 miles 4 1/2 hrs on River

DIFFICULTY: Easy To Black Rocks (Dangerous whirlpools) Easy after

PUT IN: Black Rocks To Westwater

Loma Boat Ramp
262 miles from Denver
5-5 1/2 hr. driving Time.

TAKE OUT:
Westwater Ranger station in Utah.
29 2000 miles from Put-In

CAR SHUTTLE TIME: 58-mile round trip
1 h. 40 minutes to shuttle.

DESCRIPTION OF TRIP

Put in at Loma, float scenic Horsehair & Ruby Canyons.
when you come to a large Island (at high water) group
(about 19 miles)
The canoes at Black Rocks start about 1/2 mile down
river. If water is high the canoes can maneuver thru
rock field on right side of ^{the} Black Rock in middle of
river. If forced to go left channel, stop to look
at turbulence and/or whirlpools. Camp at Black Rocks,
hike NTE trail up to top of Flat Top for scenic overlook
Paddle out 2 miles following morning.

5
2
2
2
2

NOTE: Trip leaders are responsible to complete and mail trip report
to the RMCC president for the RMCC trip report library after
every trip.

NOTE: We found out how hazardous the whirlpools are.
Our 16 1/2 ft canoe was pulled stern down leaving canoe
perpendicular to river with 11 ft underwater. Thus

caution at Black Rocks is advised during high water.
wear comfortable life vests at all times on river.

TRIP REPORT

RIVER: Conejos

DATE OF TRI: May 24-26 (Mem day)

WATER LEVEL: Medium

LENGTH & TIME: 2 days - Alternate to 3 day Rio Grande - very windy

DIFFICULTY: Int.

PUT IN: Elk Creek CG (could put in at Spectacle Lake CG for longer trip)
~ 8 hour drive from Denver.

TAKE OUT: Aspen Glade CG

CAR SHUTTLE TIME: 1/2 hour 1 way - follows river
1 hour to Spect. Lake

DESCRIPTION OF TRIP

Treed lined winding river (Would be more green in June)
One class III rapid on S turn with chute blocked by rock in middle. Other rapids Class I + II
Can be chilly - alt ~ 7000'. Nice camping. Short shuttle, exciting water - a great trip.

Jeff Keeler

NOTE: Trip leaders are responsible to complete and mail trip report to the RMCC president for the RMCC trip report library after every trip.

TRIP REPORT

RIVER: White

DATE OF TRIP: JUNE 7 + 8, 1980

WATER LEVEL: High (bank to bank but well below flood level)

LENGTH & TIME: 30 miles; 4 hrs. on water; Avg. speed 7.5 mph

DIFFICULTY: Intermediate

PUT IN: Meeker City Park (Campsites are available in the park on both sides of the river (connecting bridge). Sites include table benches and elevated grill. Area is quite clean. Launch can be done any place but best area is south bank of river downstream of bridge. No fee for tent camping.

TAKE OUT: Rio Blanco Lake Recreation Area. This is a large, unattractive recreation area, 18 miles west of Meeker via Rte. 64. We followed dirt roads to south east corner of area where one can get car to within 5 ft. of river.

CAR SHUTTLE TIME: 50 min. Go west on Rte. 64 to RBLRA - spot cars and reverse direction to Meeker.

DESCRIPTION OF TRIP

Due to last minute cancellations trip was reduced from 6 boats to 2. Shyne's was leader/sweep and Lynn Barry + Bill Murray were sweep/leader. Current was very fast but not dangerously so. One could easily pull to shore at almost any point desired. The river is a classic meander stream and runs through beautiful ranch country. River width averages 75 ft. and the numerous turns and trees in river could all be easily ^{negotiated or} avoided. No bar wire was encountered. There were small, easily avoidable standing waves at the outside of each bend. A local rancher gave us permission to camp on his land at river side. He was very cooperative!!! No rapids on stretch done.

NOTE: Trip leaders are responsible to complete and mail trip report to the RMCC president for the RMCC trip report library after every trip. Name of rancher was Irv Sholts.

Future trip leaders should try and get BLM map (9-0-0) from local BLM ranger (Meeker) which shows 2 parcels of BLM land along river. All in all a fine trip, well worth repeating, but at the water level run must be up-graded from EASY to INTERMEDIATE. JDS

TRIP REPORT

RIVER: GUNNISON RIVER

DATE OF TRI: JUNE 21, 1980

WATER LEVEL: HIGH RIVER RUNNING AT 6000-7000 CFS
LENGTH & TIME: ACCORDING TO CHESTER RUSSELL, ALMONT RESORT
RAFT RUNNER 641-0403

DIFFICULTY: 18 MILES - 4 HRS. 20 MINS (40 MIN. RESCUE)
80% CLASS II 20% CLASS III

PUT IN: SAND BAR ACROSS FROM SILENT SPRUCE
SIGN AND ALMONT RESORT IN ALMONT

TAKE OUT: COOPER'S RESORT OR NEVERSINK RESORT

CAR SHUTTLE TIME: 1 HOUR WITH SCOUTING RIVER

DESCRIPTION OF TRIP

BEAUTIFUL TRIP. NO OBSTRUCTIONS WITH
SEVERAL OVERHEAD BRIDGES. RIVER WIDE -- LOTS OF
CHOICE IN SELECTING INDIVIDUAL COURSE. A MUST
TO RUN EVERY JUNE JUST A WEEK OR TWO AFTER
IT CRESTS. WE ESTIMATED THAT WE DID 20 MILES
IN 2 1/2 HRS. OF STRAIGHT RIVER TIME. HARDEST PART
WAS A CLASS III SET OF RAPIDS NEAR PALASADES
TOWARD END OF TRIP NEAR TOWN OF GUNNISON.

NOTE: Trip leaders are responsible to complete and mail trip report
to the RMCC president for the RMCC trip report library after
every trip.

CONTACTS: ① KYLE MCDWELL - FOREST SERVICE RANGER 641-0403
* ② DOUG BUZZELL - BLUE HOLE SUPPLIER
CRESTED BUTTE 349-6431
* ③ CHES RUSSELL - RAFTER, ALMONT RESORT 641-1009

TRIP REPORT

RIVER: South Platte, 40 mi. N.E. of Denver.

DATE OF TRIP: June 22

WATER LEVEL: Descending from peak runoff period, quite high.

LENGTH AND TIME: About 5-6 river miles. The trip takes less than two hours if done non-stop, however, a lunch on one of the scenic islands in the river and some breaks can easily double that time.

DIFFICULTY: Beginner trip, Class 1 with no rocks or rapids.

PUT IN: On the St. Vrain River 1/2 mi. north of the St. Vrain Nuclear power plant just north of Platteville, Colorado. Take U.S. 85 north to Platteville from Denver, or, alternately, Interstate 25 N. to state 66 and go east 6 mi. to marked turn, then L. 2 mi to Nuclear Plant.

TAKE OUT: At Milliken Bridge on State 60, reached by going N. of Platteville on U.S. 85 4 mi and taking a L. to bridge 3 mi. N. of turnoff. Distance, one way from put-in to take-out: 13 miles, hard surface.

CAR SHUTTLE TIME: 40 minutes round trip.

DESCRIPTION OF TRIP

This is a very easy and scenic beginner trip. Dense stands of tall cottonwood trees line the banks of both rivers. The put-in is being used as a small public park. From this point it is about one mile to the South Platte, and about five more miles down the Platte to the take-out. There is a diversion dam 1 mile above take out, indicated by concrete and steel gates on the east, or right, bank. The diversion is totally under the surface at high water, but must be watched for later in the summer. Large downed trees, or "strainers" in the river can be a real menace to the unwary boater. On shore, quicksand can be found in several spots along the river. Our group found one spot about 5' by 10'. Rattlesnakes can probably be encountered along the river on hot days, but none were observed on this trip. The water is quite warm and swimming in the river can be very enjoyable. Headwinds and thunderstorms in late afternoon are common on this trip. They are best avoided by starting early and getting off the river by mid-afternoon.

Chf Reing, RMCC
June 1980

TRIP REPORT

RIVER: ARKANSAS RIVER - BROWNS CANYON TO SALIDA

DATE OF TRI: June 29, 1980

WATER LEVEL: High

LENGTH & TIME: 12 miles, 3 hours

DIFFICULTY: High intermediate/Low advanced

PUT IN: Take Colo. 291 S. toward Salida. Very soon there is the turnoff for County 191 (just before a bridge). Go R. a few hundred yards (take R. fork) down to an old bridge. Good access to the river - no permission necessary. (Could put in at the Brown's Canyon take out but we did not in order to avoid Sidell's Suck Hole.)

TAKE OUT: Salida or below. Just before Salida is a road called "Spiral Drive." At that juncture is a bridge and a dirt access road going under the S. side (river R.) of the bridge where there is a good pull out or lunch stop. 8 miles. 4 miles downstream is another very good pullout beyond a bridge called "Stockyards" bridge (one lane leading to a stockyard). Good parking and access to the river.

CAR SHUTTLE TIME: Less than 1 hour.

DESCRIPTION OF TRIP

This section of the Arkansas contains almost continuous rapids. The Club uses the international six point rating scale. With Class 5 & 6 not runnable in an open canoe, the classes are rather broad. Nonetheless, the trip starts off with solid class 2 rapids and within the first 1/2 hour has had a couple of class 3 "situations." One of these is an "S" turn that can be pre-scouted from Highway 285 leading to Poncha Springs.

The rapids then slowly diminish into pressure waves. A small dam that is easily portaged on the R. lies about 1-2 miles upstream of Salida. The rapids then start to slowly increase back to earlier levels, with the take out below Salida lying immediately upstream of Silver Heels Rapid (see attached map) which is a straight shot version of the earlier "S" turn rapid.

This particular trip went on through Bear Creek rapid with one boat dumping, but there is not a good pull out until 1/2 mile upstream of Flume rapid, with a couple of class 3 rapids in between. After that, the rapids of Flume and Tincup would be class 4 and Cottonwood rapid a class 5; therefore, we did not venture further. An advanced trip could put in at Silver Heels rapid and

NOTE: Trip leaders are responsible to complete and mail trip report to the RMCC president for the RMCC trip report library after every trip.

go down to or through Cottonwood rapid for a trip of 20-21 miles. The section we ran could easily be run later in the year with lower water. Some rock dodging would probably be necessary.

DOWNRIVER RACE COURSE

Maintain safe highway speeds or park.
Do not attempt to pace boats!

- WATER SCALE**
- 1 - Placid
 - 2 - Slow
 - 3 - Average
 - 4 - Fast
 - 5 - Navigable
 - 6 - Dangerous
 - 7 - Very Dangerous

LEGEND

- Figures on north side of river are distances between designated points.
- ☐ Boxed figures indicate nature of water
- ★ Highway distances from Junction of U.S. 50 & Colo. 291

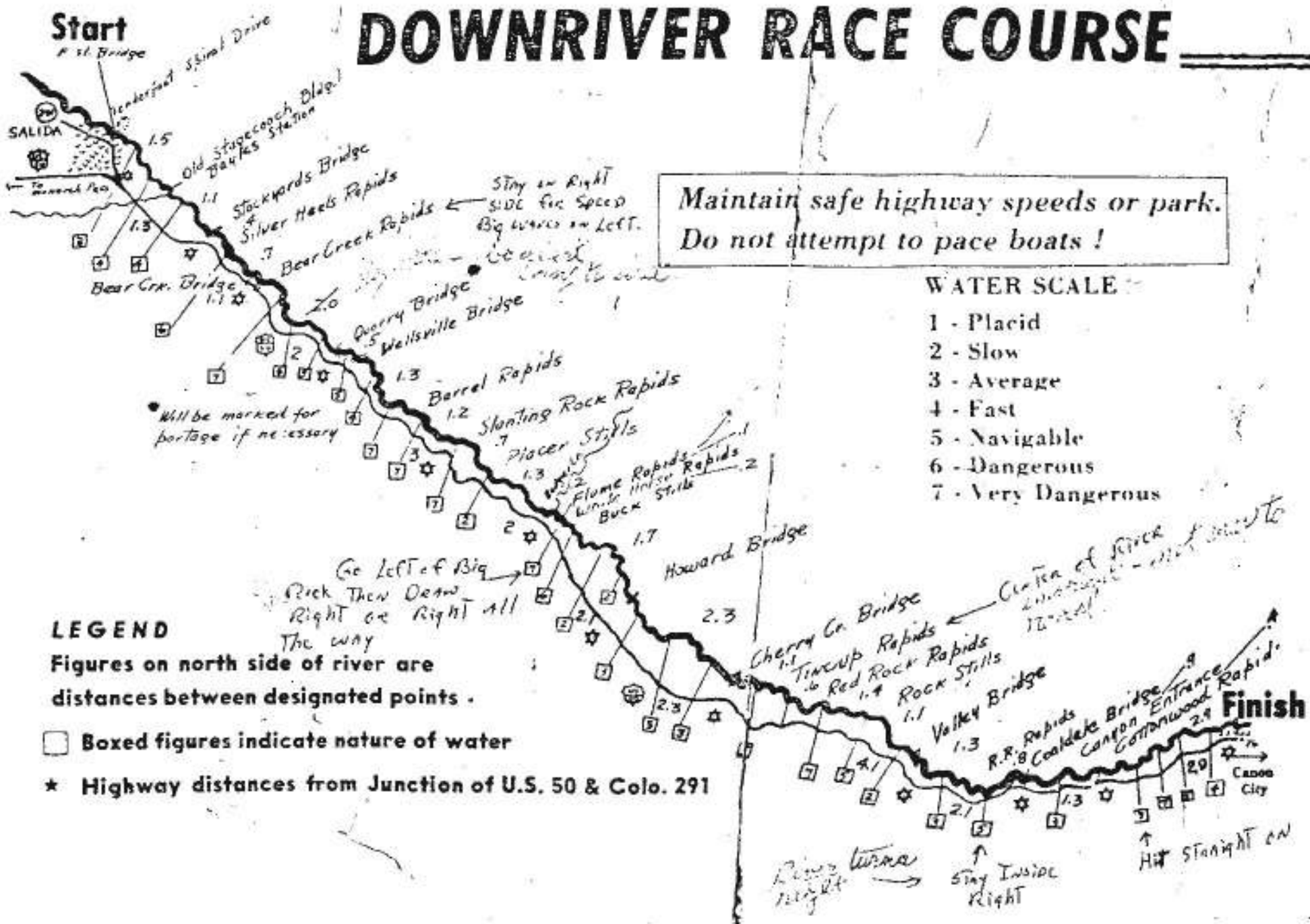

Will be marked for portage if necessary

Go Left of Big Rock Then Out Right or Right all the way

River turns right stay inside right

Hit straight on

South Platte River, South Fork -
Deebers Bridge to South Platte City (confluence
with North Fork)

Rated Intermediate

July 1, 1979.

Flow - near maximum

Length, about 11 miles. Guttle, 50 minutes.

The drive from Denver is about 4.5 miles through
Sedalia. The last part is slow and dusty, a flow
1 1/2 hours.

The water was warm from flowing over the
spillway of Cheesman Dam, and kayakers
were minimal. The lack of hair, however, does
not mean a dull trip - a finer exercise in
rock dodging would be hard to find. The "slot"
was running full enough to cover that sharp rock
just left of center, but the highly aerated
water, ^{at least} had too little density to float ~~a~~ two men in a
canoe. Lys. Perry made it, paddling single, however.

The best put-in is at the bridge about two miles
below the campground. The campground put-in
involves about two miles of floating over private
lands. Numerous takeouts are available at
picnic grounds along the stream.

St. Vrain and Tom the ~~Little~~ Rivers
Fort. St. Vrain to Greeley

Easy

July 8, 1979

Flower - just enough
Length 18 miles ^(short) Shuttle about an hour.

The put in is about 43 miles from Denver
or the St. Vrain a mile north of that nasty
old nuclear plant. To get there take I-25
north to the Platteville exit, then east on Colorado
Rd 66, and south on Wild County Rd 19.

The water was warm enough for swimming.
Shallow water, a few swags, blind channels, two
low irrigation weirs and one overhanging one
from the feedlots on shore are the major hazards.
About 1/2 mile above the takeout at Evans bridge
most of the river is diverted into a large irrigation
canal. At that point it is necessary to slide the boats
down a four-foot dam.

The takeout under the Evans bridge affords
good parking in the shade, but there is some danger
of irrigation overflow forming large puddles on
the road ^{leading} under the ~~top~~ bridge, thereby trapping
the cars.

TRIP REPORT

RIVER: SNAKE RIVER

DATE OF TRIP: JULY 5, 1980

WATER LEVEL: APPROX 6000 CFS

LENGTH & TIME: 20 MILES 4 HRS. 20 MINS. (2 Boats)

DIFFICULTY: CLASS II (Heavy duty head wind in pm)

PUT IN: PACIFIC CREEK

TAKE OUT: MOOSE

CAR SHUTTLE TIME: 1 HR. 45 MINS. (IN Nat. Park -
SLOW GOING)

DESCRIPTION OF TRIP

Beautiful float trip with the view of the
Grand Teton Mts. in background. At one point
the river passes through a Bald Eagle Reservation.
We spotted 1 Buldie on a branch over river.

* MUST GET Boat permit from Visitor Center
at Colter Bay (No cost).

* Spoke to River Running Rangers at mouse + Colter
Bay for boating info.

NOTE: Trip leaders are responsible to complete and mail trip report
to the RMCC president for the RMCC trip report library after
every trip.

(NEW CLUB ^{TRIP REPORT} TRIP)

RIVER: Roaring Fork

DATE OF TRI: July

WATER LEVEL: Med

LENGTH & TIME: @ 12 miles / 6-8 hrs depending on Lunch, Dumps,

DIFFICULTY: 1st ^{Playing time} ~~half~~ easy - moderate, Last Half moderate - difficult - Rock picking + large standing waves, some off angle.

PUT IN: Carbondale exit from Colo 82 Southbound out of Glenwood Spgs. go Right at first Carbondale exit South from Glenwood + go over bridge. Make 1st left across from gas station to 1st left (Dirt Road) which goes back down to River.

TAKE OUT: West Glenwood, 170 on north side where rafting outfitters have trailers.

CAR SHUTTLE TIME: 30-45 mins.

DESCRIPTION OF TRIP

The Roaring Fork runs thru a beautiful valley north from Aspen and joins the Colorado at Glenwood Springs - Colo. 82 follows the river from some distance. Putting in in somewhat steep river banks, for the 1st part of the trip there is a spectacular view of Mt. Sopris. The river meanders thru some meadows + grazing land and runs swiftly with little obstruction. There are some fun riffles which require some navigation and several points where the river splits and rejoins. As the trip approaches Glenwood there are more signs of civilization with some lovely homes visible on the river banks. At this time the banks get steeper, the river narrows and more rocks have to be negotiated. As well, the current gets swifter with many stretches of white water, standing waves, cross currents, etc to be navigated making the latter half of the trip an exciting ride! Early - mid July is the ideal time to run this as the water isn't too cold, the weather is good, the water level is not too high. This makes for a fun, somewhat technical

NOTE: Trip leaders are responsible to complete and mail trip report to the RMCC president for the RMCC trip report library after every trip.

TRIP without a great danger of Swamping, hypothermia, etc.
a most enjoyable trip!

TRIP REPORT

RIVER: POUDBRE RIVER - Fort Collins to Windsor

DATE OF TRIP: July 6, 1980

WATER LEVEL: Low (This trip should not be run any later than late June.)

LENGTH & TIME: 15 miles, 6-7 hours

DIFFICULTY: Easy (except for down trees in river, etc.)

PUT IN: Go 2 miles west on Colo. 14 towards Fort Collins from I-25 to dark green "Fort Collins Nursery" sign on south side of road. There is a dirt access road to the river and there is good parking.

TAKE OUT: Drive 7 miles south on I-25 to Exit 262 (Colo. 392 to Windsor) and go east 2 miles to bridge. Park along highway, not on dirt access road. Fenced area but have no problem with landowner - watch out, fence is electrified.

CAR SHUTTLE TIME: 30-40 minutes round trip.

DESCRIPTION OF TRIP

A long trip but quite nice when water is high enough to decrease the total time on the river. Even a small, efficient boating party must take time to portage several obstacles. The known obstacles are listed but acts of nature and man combine to make new ones. Lead boat needs to be enough ahead to allow time to get to shore and stop the party if necessary to explore new hazards.

5-10 minutes into trip is a large downed cottonwood tree which may need to be portaged.

20 minutes into trip is a 4' dam, after passing a concrete bridge. It can be portaged or you can take a river cut-off to the right that has one short severe rapid that should be portaged. Another dam must be portaged just after the river and the cut-off rejoins.

2 hours into the trip is a 2' dam, which can be run at high water or portaged.

2:15 hours into trip - down tree to be portaged.

2:45 hours into trip - down tree to be portaged (just before 1st of 3 fairly close together bridges (middle one is RR trestle) before lunch stop)

3 hours into trip - lunch stop at I-25 rest area. Hard to see from the river, so after 3rd bridge, watch for small island at top of a small rapid - pull-out spot is immediately to the left. Allow 1 hour for lunch.

30 minutes after lunch is an electrified fence (after a bridge and opposite a harvest gold house) that may be slid under if the water is not too high.

45 minutes after lunch is a barbed wire fence that can be slid under if someone helps by lifting it.

TRIP REPORT - DESCRIPTION OF TRIP
continued

50 minutes after lunch is another barbed wire fence across a rapid that must be lined through or portaged.

1:30+ hours after lunch is a huge 10' dam. Portage on right side is now more difficult with addition of new fencing. Must shuttle boats over the top of a barbed wire fence.

2:30+ hours (10 minutes from final take-out) is a road bridge with an electrified single strand on the downstream side which can be slid under if water level is not too high. On a scouting trip, the strand could be raised higher above the water by adjusting non-electric guy wires from the bridge.

NOTE:

Trip leaders are responsible to complete and mail trip report to the RMCC president for the RMCC trip report library after every trip.

South Platte River - Six Mile Gap
C.G. to Plattner Ranch C.G.
Intermediate (see flow)

July 21, 22, '979 (overnight, casual camping)

Flow - "A little over 1000 cfs"

Length - 3.8 miles

Down from River, 16.8 miles, through
Walden. Allow 3 1/2-4 hours

A challenging rock dodging trip, but
rather benign at this flow. There were no holes,
big haystacks or hazardous snags (quite a
contrast with the 1978 trip, when the river was
running 3800 cfs!) The trip should not be called
"easy" at any water stage, however, as "easy" trips
tend to attract floaters as opposed to paddlers. Because
of its length, remoteness, and frequently windy
conditions, much hard paddling is required.

Camp near Piaroon (or Douglas Creek)
campground. Camping gear should be carried
in water proof bags in the boats, well secured.

TRIP REPORT

RIVER: COLORADO RIVER - Dotsero to Hanging Lake with optional hike to the lake.

DATE OF TRIP: August 23, 1980

WATER LEVEL: High for this late in the season

LENGTH & TIME: 8.5 miles, 5 hours with 1/2 hour lunch

DIFFICULTY: Easy

PUT IN: Gravel parking lot at Dotsero bridge on the old highway. Lot is large and has excellent access to the river.

TAKE OUT: Hanging Lake Rest Area, 10 miles east of Glenwood Springs.

CAR SHUTTLE TIME: Less than 1/2 hour.

DESCRIPTION OF TRIP

A very good end of season trip, but because of the 2 1/2 - 3 hour drive from Denver and probability of upstream winds in the afternoon, it is advisable to try to have the car shuttle done and be ready to boat by 10:00 a.m. Three Class I rapids. Just below the 1st one is a sand bar on the left where there is a hot spring. The 2nd rapid has the highest standing waves of the 3, but is short with no obstructions. Good lunch spot at Tie Gulch (optional pull-out if bad weather) just below the 3rd rapid, where there is a large sandy beach area. Tie Gulch is 5 miles into the trip.

Mike Hardesty

TRIP REPORT

RIVER: Colorado

DATE OF TRI: 7/26/80

WATER LEVEL: Medium low \approx 1100 cfs (according to ranger)

LENGTH & TIME: approx 15 miles - 6 hours

DIFFICULTY: intermediate (at this level)

PUT IN: Pumphouse

TAKE OUT: Radium

CAR SHUTTLE TIME: 1 1/2 hours

DESCRIPTION OF TRIP

Nice trip - Beautiful Day. Lots of rafts on this stretch. May have some trouble with BLM ~~down~~ ⁱⁿ the future. Ranger told me he was "officially discouraging open canoes" on this stretch, since apparently a number of boats had ~~had~~ ^{some} trouble earlier.

Trip has 2 canyons separated by some flat water. First canyon (Needles Eye) can be run without scouting. Long rapid, but not big. Second canyon (Red

NOTE: Trip leaders are responsible to complete and mail trip report to the RMCC president for the RMCC trip report library after every trip.

Gorge) has a nice rapid at the bottom. Start left and work right-center and it's no sweat. Below the canyon there's another flat spot before Radium →

Dul Rio, then a stretch of ^{intermittent} short, easy, fun rapids into State Bridge.

Note: Since the river flows to the southwest, the winds can be murder on this stretch in the summer. Suggest an early start on the river.